



ONCE YOU **PASS**
THROUGH THE
SURFACE OF THE
IDEA, IT ALL COMES
POURING OUT

Charles Blackman

[THE BLACKMAN]



MEETINGS & EVENTS

Searching for hassle-free meeting, conference and event spaces? Step into The Blackman.

Just a hop, skip and jump from the Melbourne CBD, The Blackman is centrally located on Melbourne's business boulevard.

With state-of-the-art technological solutions, flexible room setup and a range of in-house catering options, The Blackman has you covered.

Disappear down the rabbit hole and discover meetings and events done a little differently.

CONFERENCE, MEETING & EVENT FACILITIES

- Six inspiring conference & event spaces
- Boutique spaces for up to 100 people
- Flexible setup options
- Stunning Melbourne views
- Flat screen TVs with data connections in our Galleries & Penthouses
- Data projector and screen
- Individual heating and cooling systems
- iPod docking station
- Whiteboard & flipchart
- Wireless internet
- Invaluable Event Management expertise
- Conferencing Concierge
- Mouth watering in-house catering
- Multiple inspiring artworks in all event spaces
- Art Curator on request
- Close to public transport
- On-site parking



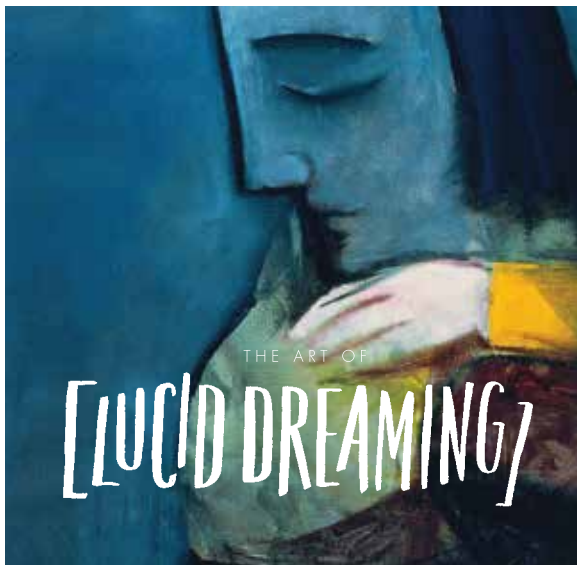

Taking its design cues from Charles Blackman's *Alice in Wonderland* series, The Blackman's striking meeting and event spaces provide plenty of scope for you to create a successful Melbourne event. Invite delegates to step into their own delight by reserving one of The Blackman's flexible galleries, or even a penthouse.

GALLERIES I, II, III, & IV

The Blackman offers four unique spaces for meeting and events in Melbourne. Accentuated with stylish designer décor and contemporary furniture, The Blackman galleries are simply striking. These unique meeting and event spaces can be hired individually or combined, offering ultimate flexibility in setup.



THE READING PENTHOUSE

The Blackman's Reading Penthouse overlooks the twinkling lights of Melbourne's CBD and offers an unforgettable experience in a boutique designer inspired setting. At 95 square meters, there's plenty of room to let your imagination run wild.



THE GARDEN PENTHOUSE

The Blackman's Garden Penthouse offers magical views over Albert Park. Accentuated by a wrap-around balcony and with plenty of fresh air and natural light, the environment is conducive to generative thinking. Ideal for vibrant meetings and productive discussions, this function space is sure to make an impression.

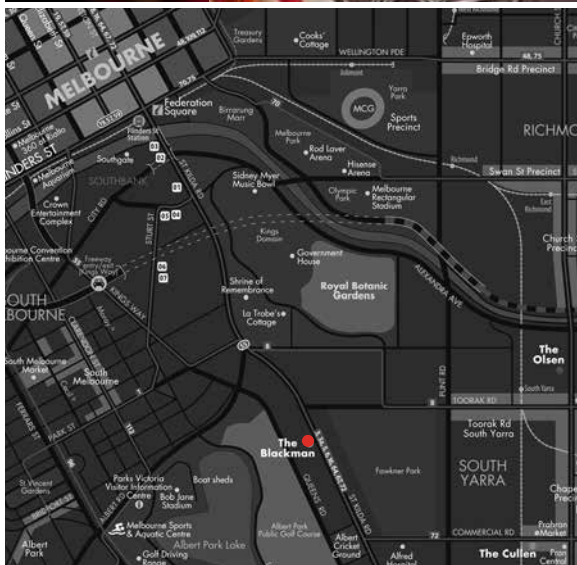

Spaces	Dimensions MxM	Gross Area Sq M	Capacity (Number of Persons)							
			Boardroom	Theatre	Classroom	Banquet	Cabaret	U-Shape	Cocktail	Fashion Launch /Showings
Gallery I	6.5x5.5	34	10	20	12	NA	NA	NA	NA	✓
Gallery II	6.8x6.8	46.7	10	20	12	NA	NA	10	NA	✓
Gallery III	6.7x8.7	58.7	14	30	18	NA	NA	14	NA	✓
Gallery IV	7x10.5	75.4	12	30	21	NA	20	18	40	✓
Reading Room Penthouse	NA	95	15	20	10	12	12	10	50	✓
Garden Room Penthouse	NA	95	20	20	18	30	20	15	60	✓
Gallery I & II	6.5x12.3	80.7	20	40	30	32	25	20	50	✓
Gallery III & IV	10.5x21	134.1	40	80	50	60	48	40	100	✓

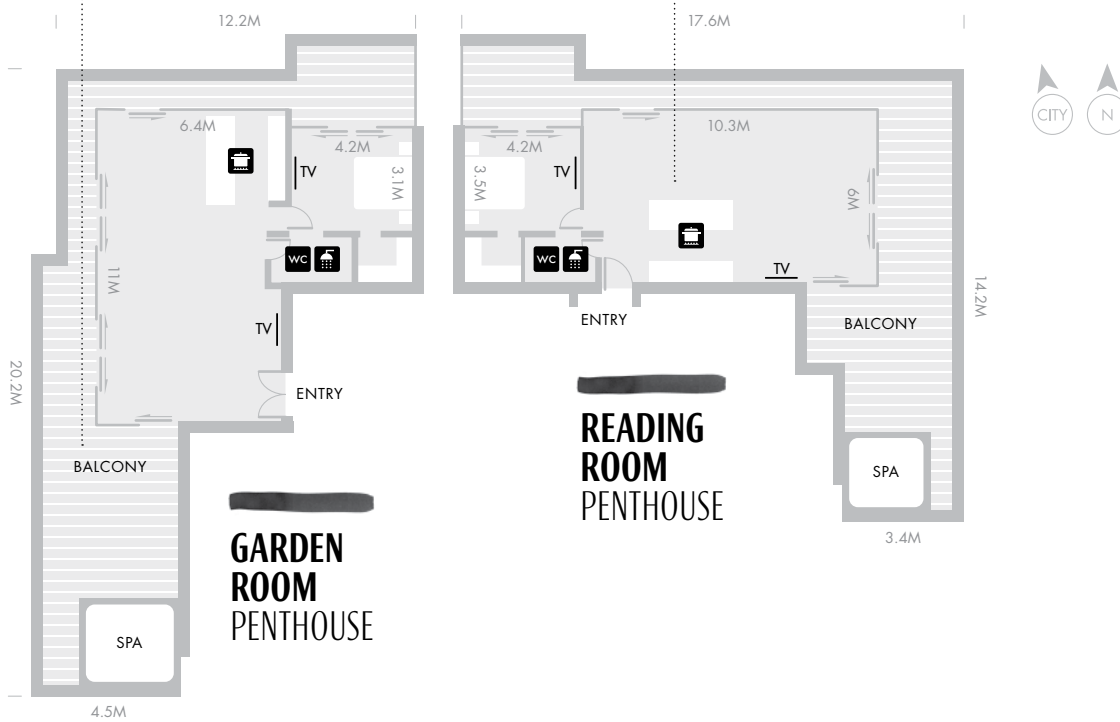

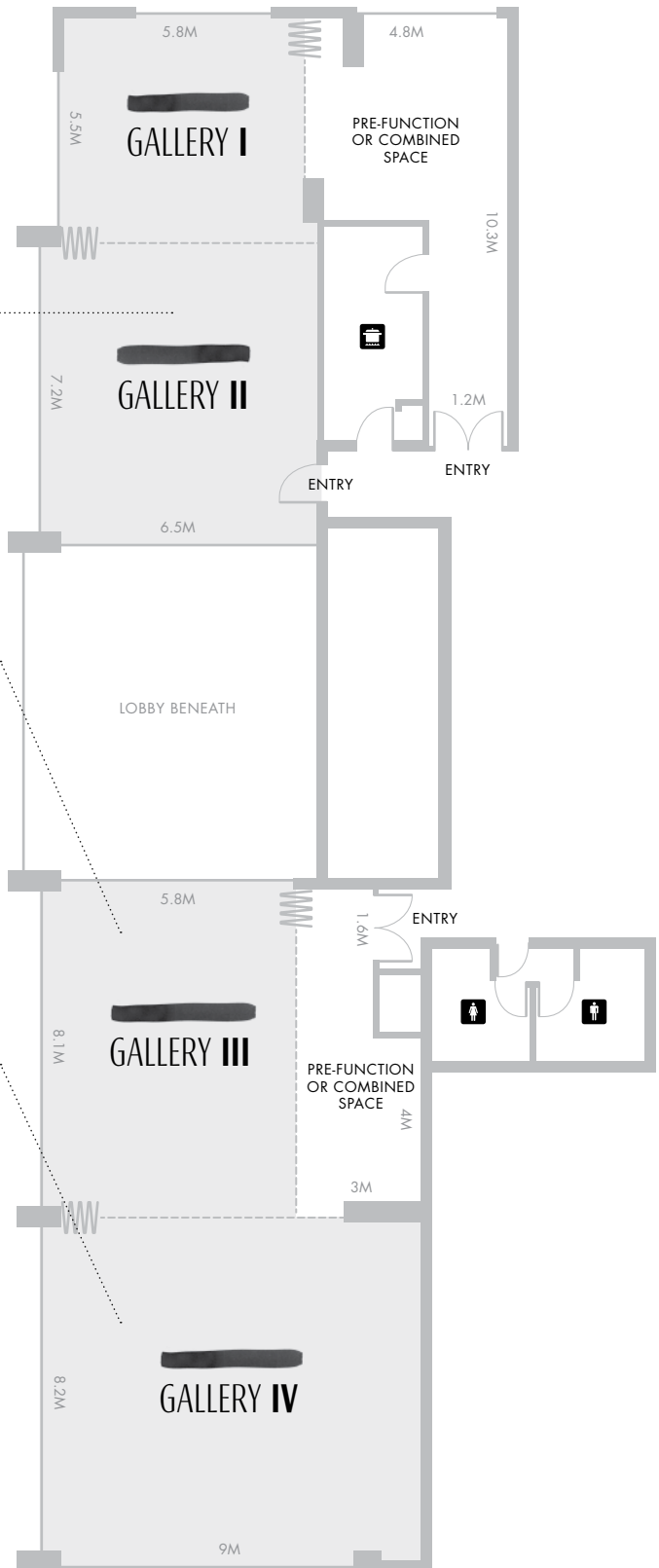

[THE BLACKMAN]

452 St Kilda Road
Melbourne VIC 3004

Call the Conference & Events team
on (03) 9040 1242

events@artserieshotels.com.au
theblackman.com.au

